

# 5. EXPLODED VIEWS AND PARTS LIST

- NOTES:
- Parts marked by "NSP" are generally unavailable because they are not in our Master Spare Parts List.
  - The  $\triangle$  mark found on some component parts indicates the importance of the safety factor of the part. Therefore, when replacing, be sure to use parts of identical designation.
  - Screws adjacent to  $\nabla$  mark on product are used for disassembly.
  - For the applying amount of lubricants or glue, follow the instructions in this manual. (In the case of no amount instructions, apply as you think it appropriate.)

## 5.1 PACKING SECTION



### PACKING SECTION PARTS LIST

Mark No.	Description	Part No.
1	1.2 m Coiled cable (extended length 1.8 m)	20030235000020D01
NSP 2	Instruction manual (En, Fr, De, It, Ni, Es, Pt, Ru, Zhcn, Zhtw, Ja)	•••••

## 5.2 EXTERIOR SECTION

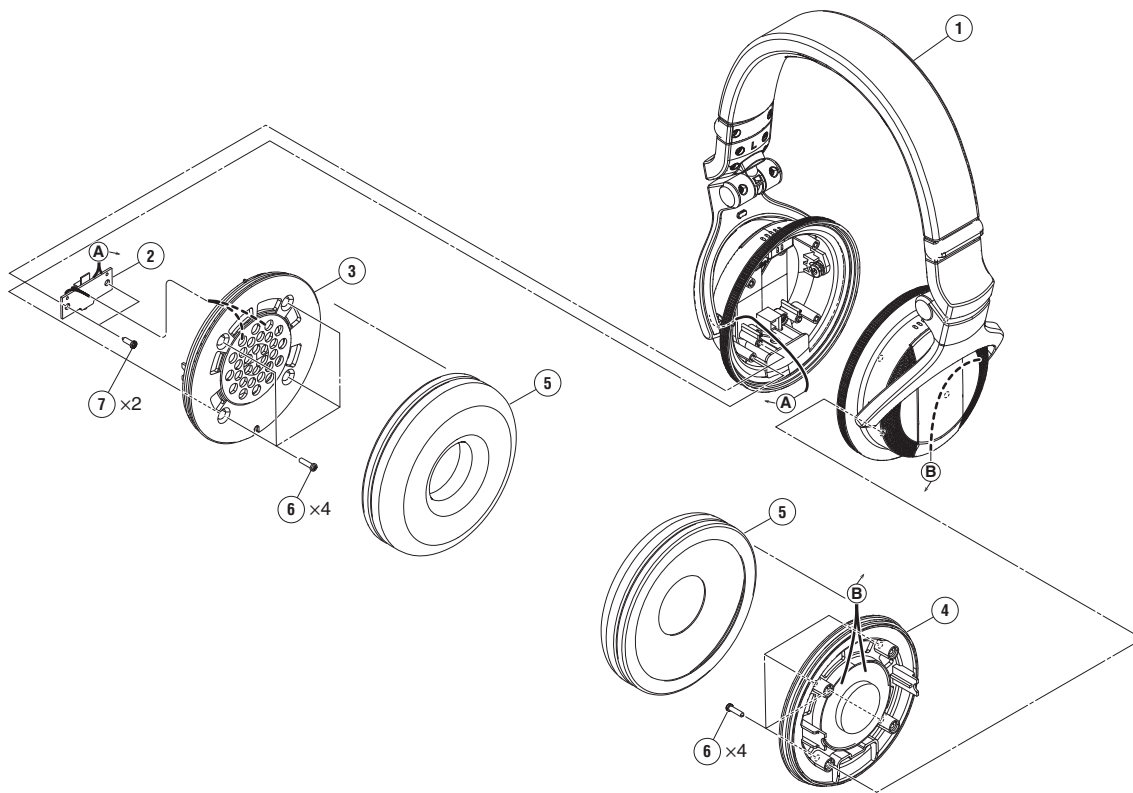

### EXTERIOR SECTION PARTS LIST

<u>Mark No.</u>	<u>Description</u>	<u>Part No.</u>
1	Headband Assy	2201016337T0100
2	JACK PCB Assy	320699220045C00
3	SP Base L Assy	240703633707D00
4	SP Base R Assy	210700633703D00
5	Ear Pad K	301001000556D00
6	Screw (SP Base)	30030220080015D
7	Screw (PCBA)	30030220050025D